



LANGUAGE APP REQUIREMENTS

To operate properly our Byteengine Translator App requires a device running the latest versions of iOS or Android. Since our translation app is always learning and adding new words, all translations are done in real time which requires you to have an active Internet DataPlan or Wifi Connection in order for the app to work.

LANGUAGE TRANSLATOR APP FUNCTIONS

The Byteengine Translator Language Translator App is a powerful app which includes the following functions.

Voice Translation Mode

This translation mode is perfect for traveling. You can speak into your device and the words will be translated both verbally and visually to your device screen. The person can then tap on the device to speak in their language and it will automatically be verbally translated to your device, while also being visually displayed on the device.

Group Translation Mode

This mode allows multiple users to easily chat with each other in a group setting while each speaking their own language. Using the App, simply set up a group translation conversation, invite people and start talking. Whether it's a meeting, dinner, conference or even from across the world, you can communicate with a group of people in real-time, each in their own language.

Image Translation Mode

This mode will help you to translate the text inside the image. You can use it to easily read menus, road signs, etc. in other languages.

CONNECTING via BLUETOOTH

Turn on the device by Long Pressing the Power Button until the LED fast Flashes in BLUE.

Go into the Apps Menu >Settings Menu>Connections Menu. > Bluetooth Menu, make sure Bluetooth is toggled ON.

"Go to the 'Available Devices' in the Bluetooth menu, then look for 'Tr box01' in the list. Please note, do not click on the 'UISLW' Bluetooth option. If you can't find 'Tr box01,' touch 'Scan' to rescan for BT devices.

Click on 'Tr box01' in the list to connect your device to Bluetooth. Your device should now be connected. After the connection, 'Tr box01' will appear under 'Paired Devices.'"

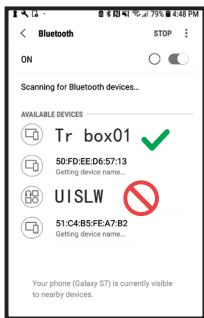

Your unit is now paired and ready to use.

Please note some Android device manufacturers use slightly varied methods for connecting devices to Bluetooth, consult your device Owner's Manual for specific instructions on connecting Bluetooth products.

Downloading the Language Translator App

Using your device, find the App Store icon or the Google Play Store icon. Then type "Byteengine Translator" in the search box and click search to install.

Turn on Peiko device and connect it to your phone.

Open the app 'Byteengine Translator' and wait for automatic connection. Please allow access for 'Byteengine Translator' when using it for the first time.

Getting Started

Make sure your Peiko Translation device is turned on and connected to yours. Launch the Byteengine Translator APP. A picture of the model number of the connected device will appear at the top of the screen, which indicates that the device is properly connected to the app and ready for translation. (If it doesn't appear, check that your device is connected to your device via Bluetooth.)

Voice Translation

When your Peiko translation device is connected to the APP, the APP will automatically enter the voice translation mode, and then set your native language and the target language for translation.

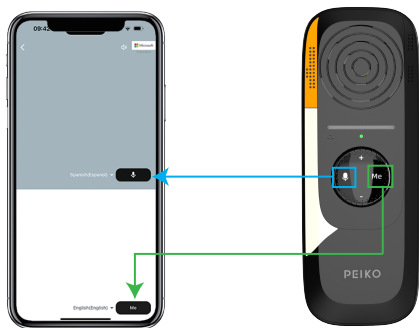

Trbox01 translation device button correspondence diagram. Through the guidance in the figure above, please set the language corresponding to the button on the Trbox device.

Once you're set up, just keep the app running in the background and Trbox will automatically interact with your phone wirelessly in the background. In the following translation process, you no longer need to operate the mobile phone, unless the connection between the Trbox and the mobile phone is interrupted, You can now use the device independently.

You can determine if the translator is working properly by looking at the indicator light on your device. The case where the indicator light is solid green means that the Trbox01 is ready for translation at any time.

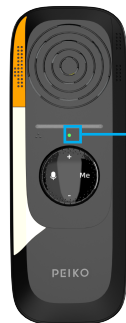

The indicator light is solid green, indicating that the device is ready for translation work.

The indicator will only be solid green when the voice translation or group chat translation is turned on in the Byteengine Translator APP and run in the background of the phone.

If your phone answers an incoming call or plays music, the connection between Byteengine Translator APP and Trbox will be interrupted, you need to reopen Byteengine Translator APP again, and wait for the device to automatically connect to the APP to use it normally.

How to talk

When you want to translate your native language, please press the ME button on the Trbox01 device, wait for the white indicator light to turn on, and start talking. (Please note that the light color of the 2 translation buttons on the device is different, the ME button is white and the light color of the translation button in the target language is green)

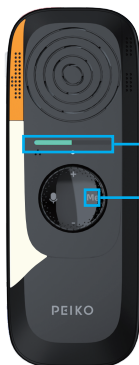

Translation indicator light,

Press the button to speak, and release the button when you're done

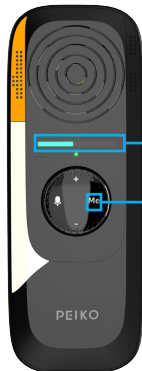

Translation indicator light,

Press the button to speak, and release the button when you're done

When you want to translate the target language, press the button of the microphone icon on the Trbox01 device, wait for the green light to light up, and then start speaking (please note that the light color of the two translation buttons on the device is different, the button of the microphone icon is green, and the light color of the ME button is white).

Group translation

This feature is specially designed for group translation. You can either join one or start a new one.

Starting a group translation

Press the group translation and enter your name. Choose your own language. For example (when you choose Chinese, whatever others speak will be translated into Chinese and played out for you.)

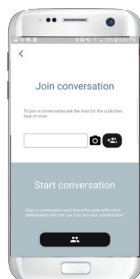

1. Group chat number
2. Settings
3. Keyboard
4. Speak and translate

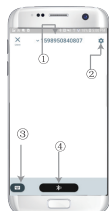

Once you are done setting up the group chat, share your group chat number with other friends who have peiko products and keep Byteengine Translator open and running in the background of your phone. You can use your Trbox translation device to have a conversation, and in the group chat mode, please click the ME button on the device to have a conversation. The operation method is the same as the method of voice translation, press the button and wait for the white translation light to turn on, then start talking, and release the button after speaking.

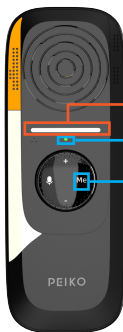

Press the ME button, wait for the translation indicator to turn white, and then start talking.

The indicator light is solid green, indicating that the device is ready for translation work.

Press the button to speak, and release the button when you're done

Please note that during the use of group chat translation, the indicator light on the Trbox also remains solid green, which means that everything is normal.
If the indicator light flashes green, please try to re-open Byteengine Translator and re-enter the group chat translation mode.



If you created a group chat translator, you can also turn on the speaker mode in the settings, which is perfect for small teams and multi-person people to communicate in different languages. Speech mode: When you choose the speech mode, new group members can only join the chat without talking. (The speech mode is only available for the one starting the group)